

Pad For 25 Thru 250 KVA SØ 7620V Transformer Including  
Mini Pad, 4800V Non-Switching and SØ ISO Pad

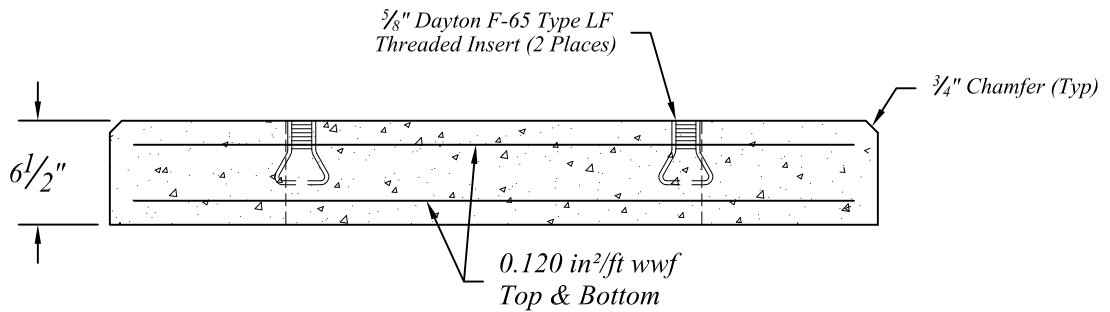
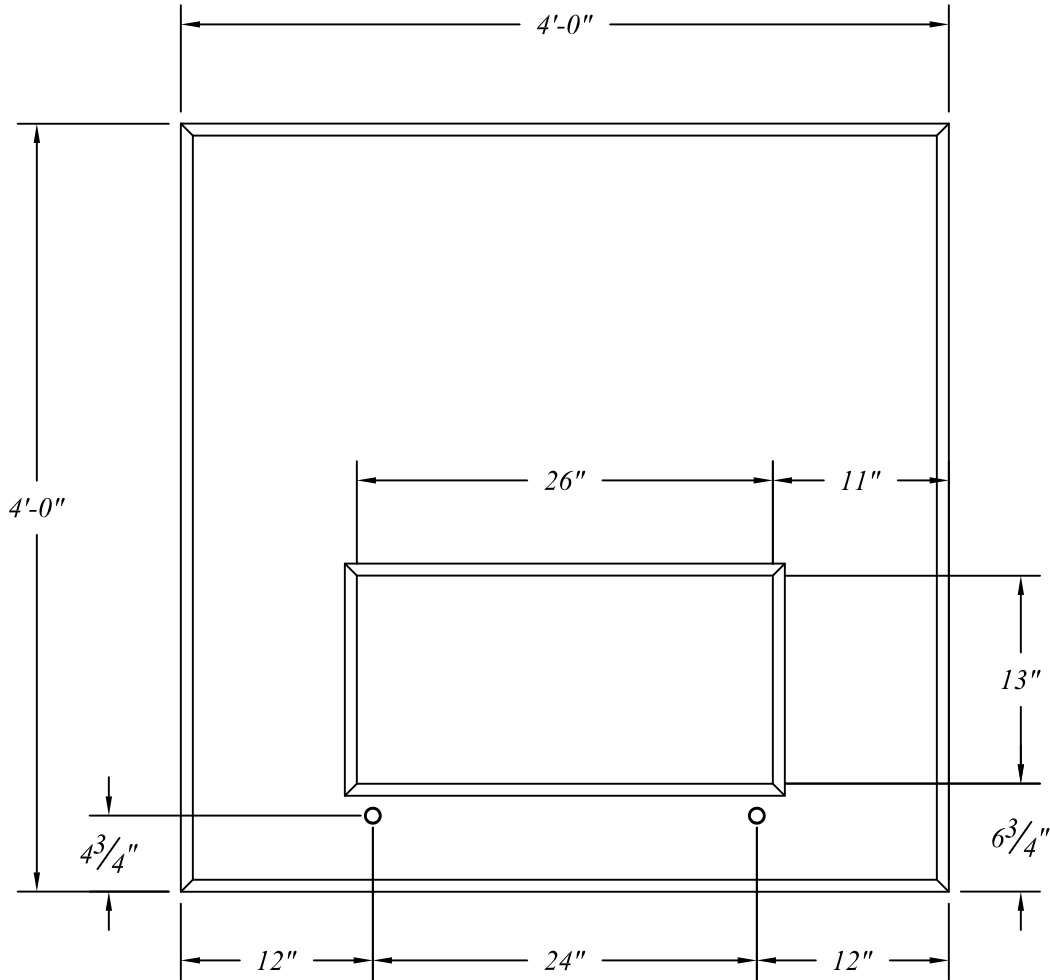

Concrete Strength: 3500 psi @ 28 days  
Steel Reinforcing: ASTM A-185/A-497, Grade 65  
Steel Cover: 1 1/2" Minimum

4'-0" x 4'-0" Precast Concrete Detroit Edison Transformer Pad

**NORTHERN CONCRETE PIPE**



401 Kelton Street  
Bay City, MI 48706  
1 800 222 9918

5281 Lansing Road  
Charlotte, MI 48813  
1 800 874 9701

Date 31 Jan 08  
Drawn By BmG

Scale NTS