

Pad For All 3Ø Non-Switching Transformers 750 KVA Thru 1500 KVA

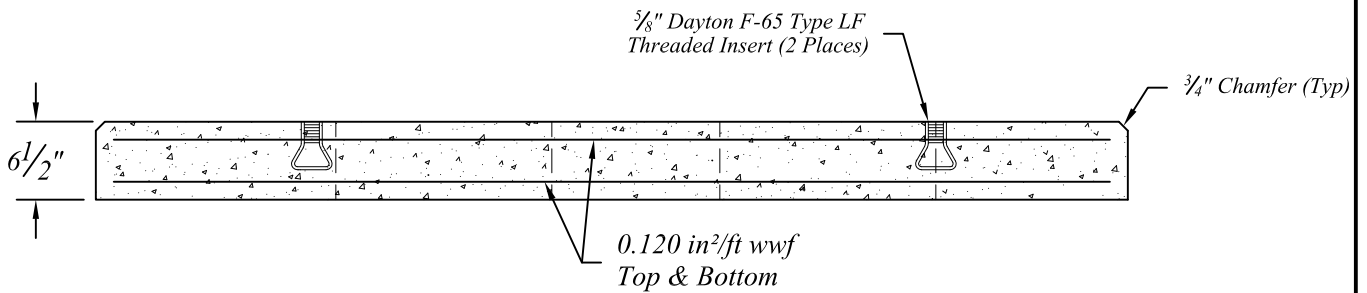
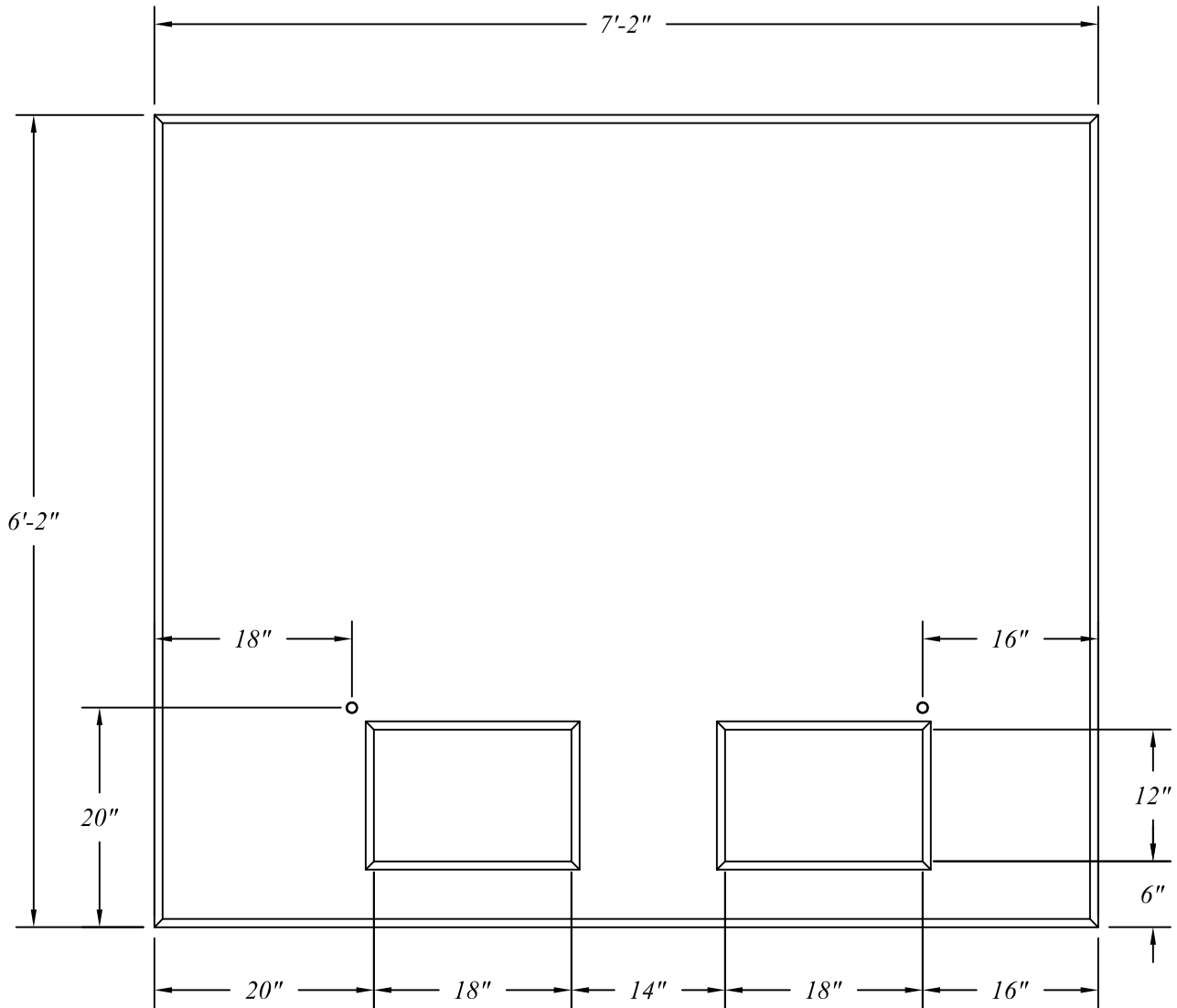

Concrete Strength: 3500 psi @ 28 days
 Steel Reinforcing: ASTM A-185/A-497, Grade 65
 Steel Cover: 1 1/2" Minimum

6'-2" x 7'-2" Precast Concrete Detroit Edison Transformer Pad

NORTHERN CONCRETE PIPE



401 Kelton Street
 Bay City, MI 48706
 1 800 222 9918

5281 Lansing Road
 Charlotte, MI 48813
 1 800 874 9701

Date 31 Jan 08
 Drawn By BmG

Scale NTS