

Pad For All 3Ø Non-Switching Transformers 750 KVA Thru 1500 KVA

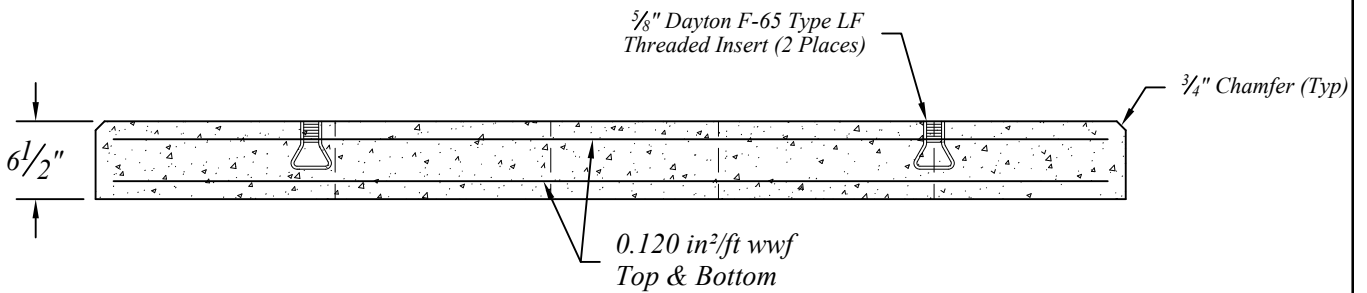
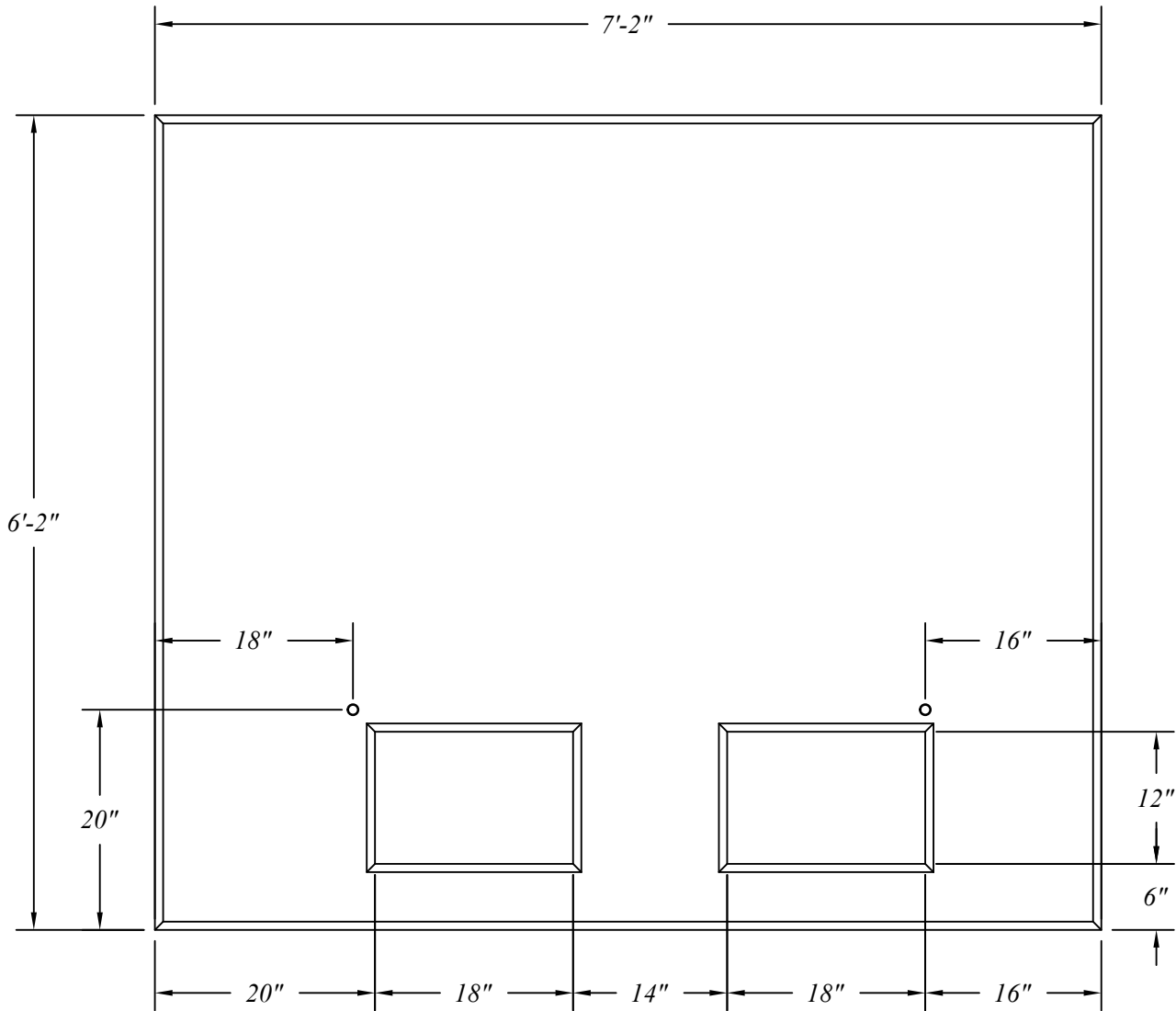

Concrete Strength: 3500 psi @ 28 days
 Steel Reinforcing: ASTM A-185/A-497,
 Grade 65
 Steel Cover: 1 1/2" Minimum

6'-2" x 7'-2" Precast Concrete Detroit Edison Transformer Pad			
	401 Kelton St Bay City, MI 48706		Date 30 Jun 15
	5281 Lansing Rd Charlotte, MI 48813	2701 Chicago Dr SW Wyoming, MI 49519	Drawn By BmG
	4950 White Lake Rd Clarkston, MI 48346	3756 Centennial Rd Sylvania, OH 43560	Scale NTS
			08.23